

SSLFHFD-FFU-RSR

FAN FILTER UNIT
ROOMSIDE REPLACEABLE

STANDARD CONSTRUCTION

- 304 Stainless Steel w/Filter Gel Seal Knife Edge
- Non-Ducted Inlet
- EC Motor with Backward Curved Composite Impeller
- 70mm Gel Seal H14 HEPA Filter - 99.995% on 0.3 µm, Room Side Replaceable
- 51% Perf Face
- Airflow Sensor
- Constant Volume
- Adjustable Face Control
- All-Welded Plenum Seams
- Lay-In / Surface Mounting
- Walkable Plenum up to 250lbs
- Hanger Tabs for Unit Support Above Ceiling

FEATURE OPTIONS

- ☐ Duct Collar Kit
 - ☐ Round - Size: _____
 - ☐ Oval - Size: _____
 - ☐ Rectangle - Size: _____
 - ☐ Flanged
- ☐ Foil Backed Insulation
 - ☐ 1.5" (R=4.2)
 - ☐ 2.25" (R=6.0)
- ☐ HEPA-Lert Filter Monitor
- ☐ Test Ports
 - ☐ 1 Port
 - ☐ 2 Ports
- ☐ PAO Challenge System (Requires 2 Test Ports)
- ☐ Continuous Filter Monitoring
- ☐ Touchscreen Wall Control (Up to 400 Units)
- ☐ Basic Wall Control (One Per Unit)
- ☐ Seismic Hanger Brackets (See Page 4) (for use with 3/8" threaded rod by others)
- ☐ Hinged Face Frame
- ☐ Hard Ceiling Clamping System

MATERIAL OPTIONS

- ☐ 316 Stainless Steel

FINISH OPTIONS

- ☐ Polished
- ☐ White Antimicrobial Powder Coat
- ☐ Other: _____

PRE-FILTER OPTIONS

- ☐ MERV 4 Washable
- ☐ MERV 8 Pleated

FILTER OPTIONS

- ☐ ULPA Filter - 99.9995% on 0.12 µm

MOTOR PROGRAM OPTIONS

- ☐ CFM Control
- ☐ RPM Control

FAN VOLTAGE OPTIONS

- ☐ 120VAC
- ☐ 240VAC
- ☐ 208VAC
- ☐ 277VAC

FAN CONTROL OPTIONS

- ☐ MODBUS
 - ☐ RTU
 - ☐ IP
- ☐ BACnet
 - ☐ TCP/IP
 - ☐ MS/TP
- ☐ 0 - 10VDC Input

LIGHTING OPTIONS (See Page 3 of 4 for Additional Details)

- ☐ Color: White; Preset at 5000K; 90+ CRI
- ☐ Color: White; Preset; 90+ CRI
 - ☐ 2700
 - ☐ 3000
 - ☐ 3500
 - ☐ 4000
 - ☐ 4500
 - ☐ 5000
 - ☐ 6500
- ☐ Color: Tunable from 2700K-6500K via 0-10VDC Dimmer; 90+ CRI
- ☐ Other Color: _____
- ☐ Battery Backup
 - 20% of Light Output for up to 90 Minutes



AJ MANUFACTURING CO.
8701 ELMWOOD AVE #400 KANSAS CITY, MO 64132
PH: 816.231.5522 FAX: 816.231.8437
TOLL FREE: 800.247.5746
WWW.AJMFG.COM

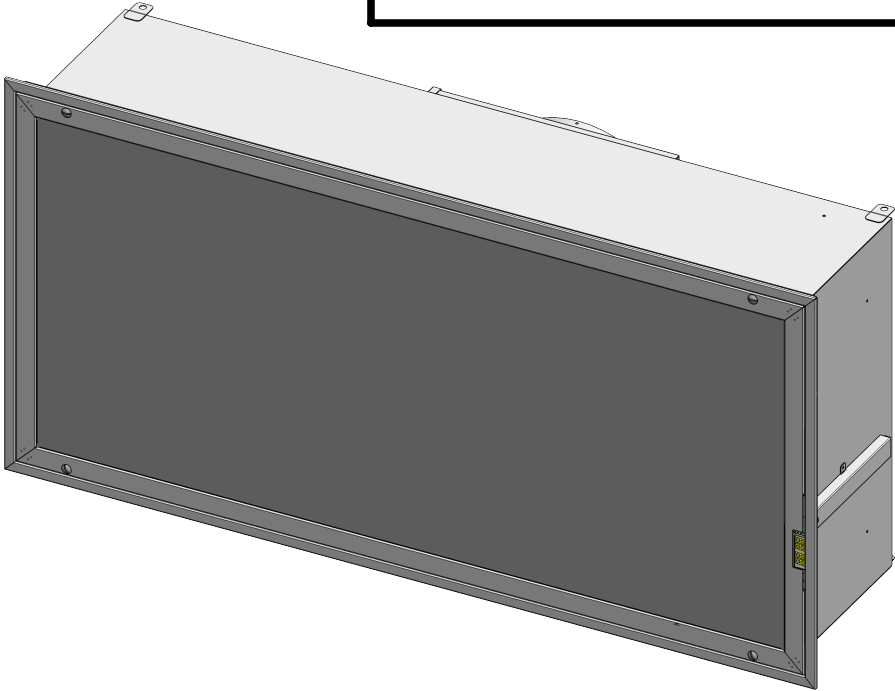

| MOTOR/ FAN | FILTER | FILTER MEDIA DEPTH | NOMINAL UNIT SIZE | OVERALL WIDTH (W) | OVERALL HEIGHT (H) | DEPTH (D) | CUTOUT WIDTH (CW) | CUTOUT HEIGHT (CH) | ACTIVE FILTER FACE AREA (SQ.FT.) | MAX CFM | WATTS AT MAX CFM | CFM AT 100 FPM | WATTS AT 100 FPM * | SOUND AT 100 FPM (dBA) | FULL LOAD AMPS (FLA) (120/208/240/277) |
|------------|--------|--------------------|-------------------|-------------------|--------------------|-----------|-------------------|--------------------|----------------------------------|---------|------------------|----------------|--------------------|------------------------|--|
| ECM-BC | RSR | 70mm | 24 X 24 | 23.75 | 23.75 | 10.88 | 23.00 | 23.00 | 2.00 | 350 | 160 | 200 | 39 | 48 | 2.2/1.59/1.38/1.2 |
| | | | 36 X 24 | 35.75 | 23.75 | 10.88 | 35.00 | 23.00 | 3.42 | 600 | 210 | 342 | 49 | 50 | |
| | | | 48 X 24 | 47.75 | 23.75 | 10.88 | 47.00 | 23.00 | 4.84 | 800 | 230 | 484 | 50 | 51 | |

* Based on 60Hz, no Pre-Filter, 0.00" ESP

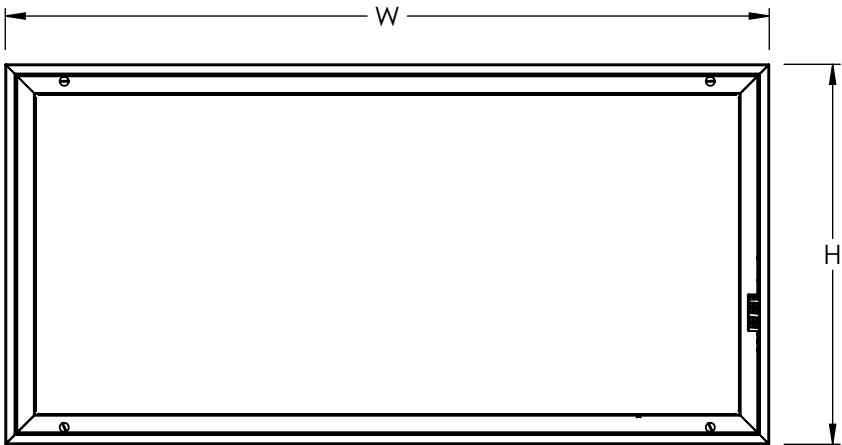
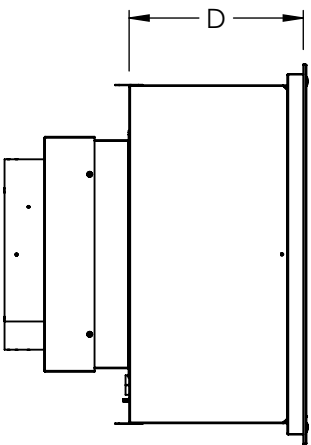
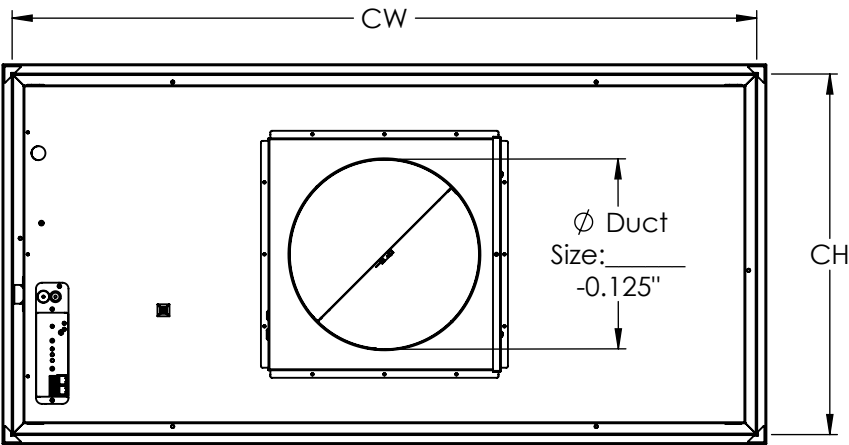

SSLFHFD-FFU-RSR
FAN FILTER UNIT
ROOMSIDE REPLACEABLE



AJ MANUFACTURING CO.
8701 ELMWOOD AVE #400 KANSAS CITY, MO 64132
PH: 816.231.5522 FAX: 816.231.8437
TOLL FREE: 800.247.5746
WWW.AJMFG.COM

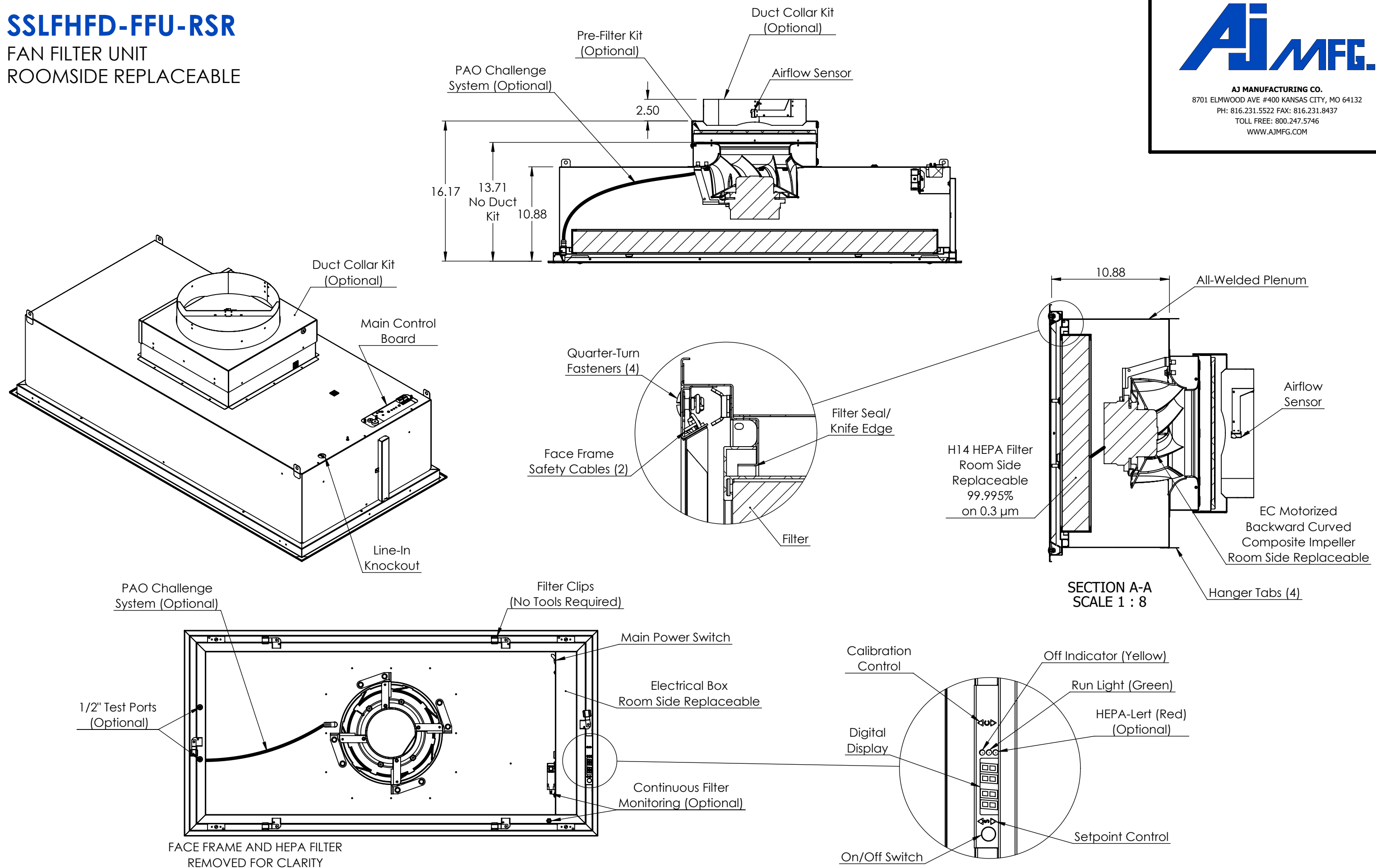

SSLFHFD-FFU-RSR-LED

FAN FILTER UNIT W/LED LIGHTING
ROOMSIDE REPLACEABLE



MEETS THE FOLLOWING UL LISTINGS

- UL 1598 - Standard for Safety Luminaires
- UL 2043 - Standard for Safety Fire Test
- UL 2108 - Standard for Low Voltage Lighting Systems
- UL 8750 - Standard for Light Emitting Diode (LED) Equipment for Use in Lighting Products
- UL 1310 - Standard for Class 2 Power Units
- UL 94 - Standard for Tests for Flammability of Plastic Materials for Parts in Devices and Appliances

LIGHTING SPECIFICATIONS

- Color: White; Preset at 5000K; 90+ CRI
- Dimmable LEDs Controlled via 0-10VDC Dimmer
- Driver - 100watt - Class 2 - 100-277VAC Input
- 120VAC = 1.05Amps per Driver **or**
- 230VAC = 0.58Amps per Driver **or**
- 277VAC = 0.48Amps per Driver

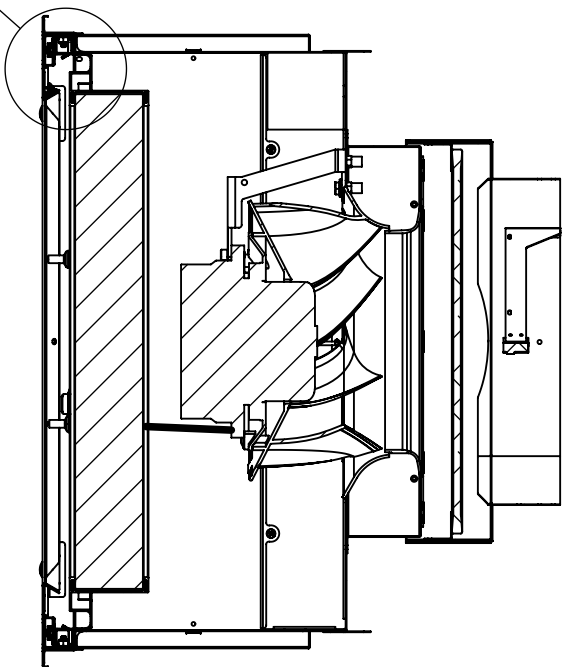
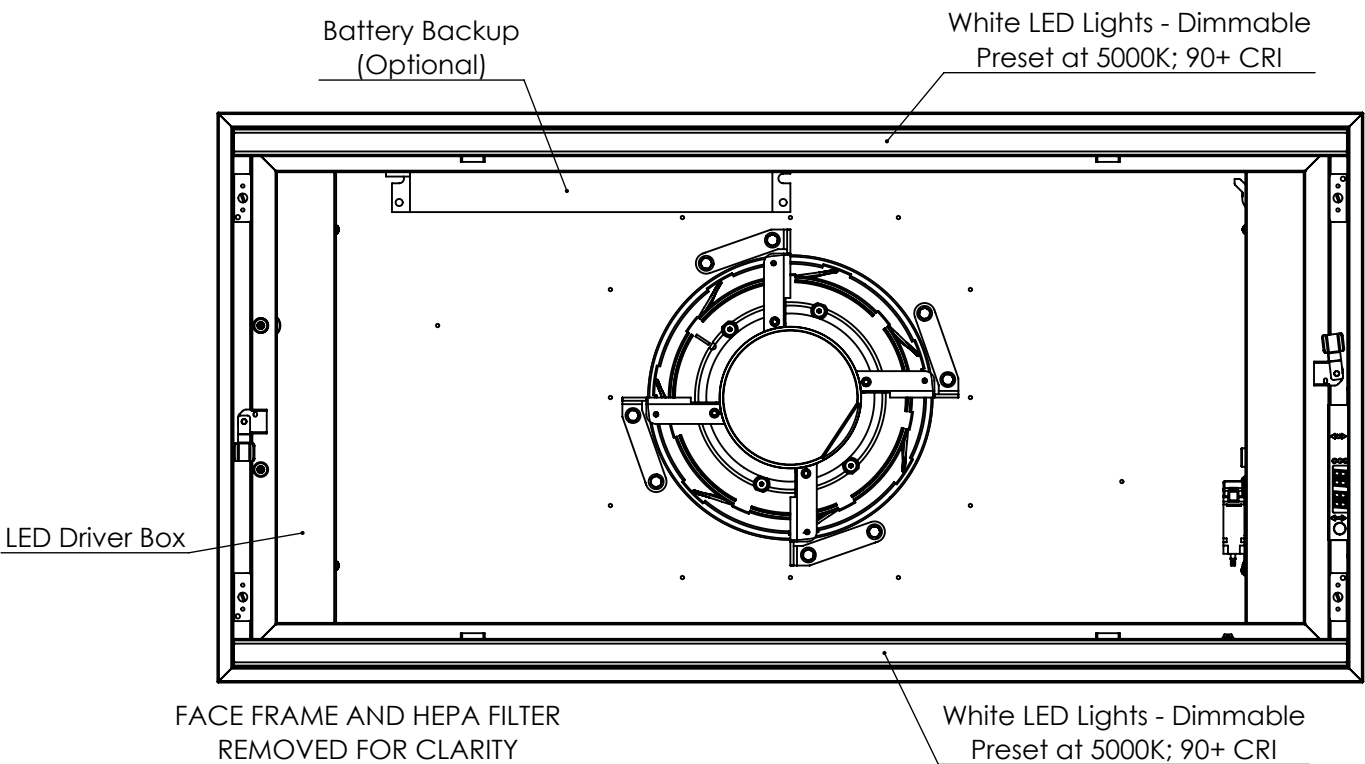
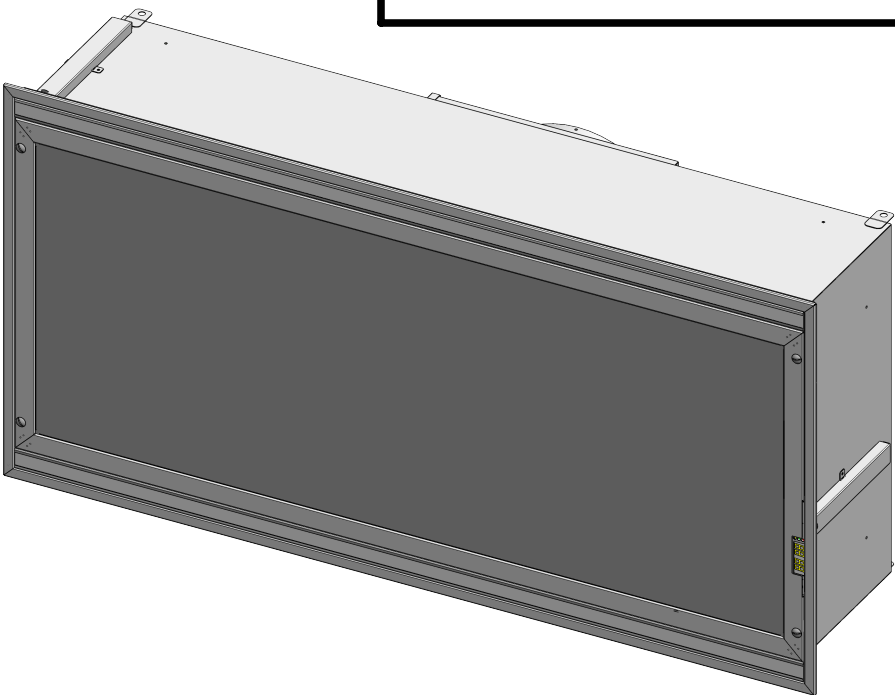
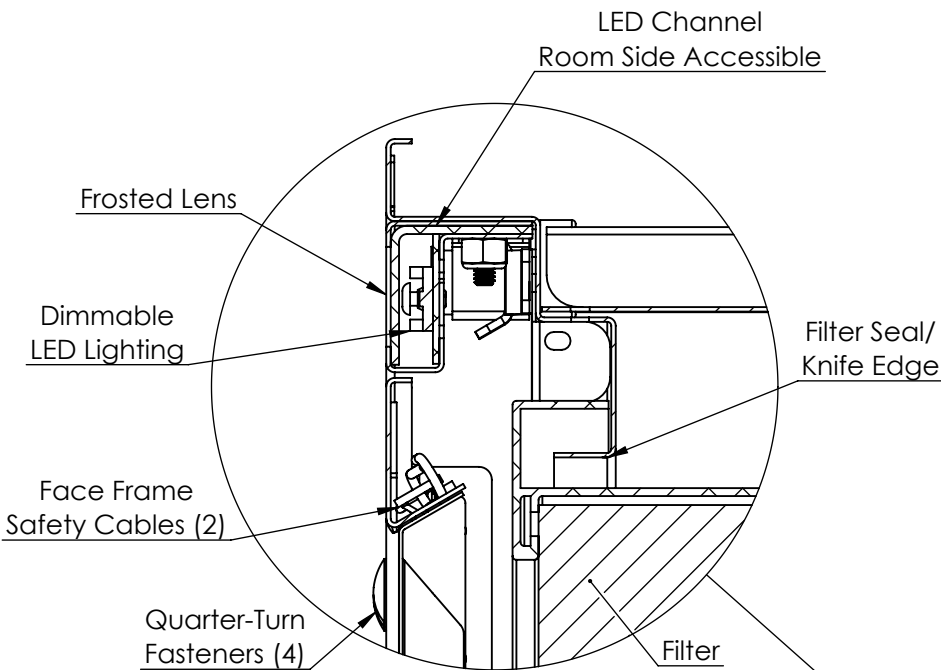

SECTION B-B
SCALE 1 : 7



AJ MANUFACTURING CO.
8701 ELMWOOD AVE #400 KANSAS CITY, MO 64132
PH: 816.231.5522 FAX: 816.231.8437
TOLL FREE: 800.247.5746
WWW.AJMFG.COM

SSLFHFD-FFU-RSR
FAN FILTER UNIT
ROOMSIDE REPLACEABLE

SEISMIC BRACKET DETAIL

Certification Link: [Reference OSP-0730](#)



AJ MANUFACTURING CO.
8701 ELMWOOD AVE #400 KANSAS CITY, MO 64132
PH: 816.231.5522 FAX: 816.231.8437
TOLL FREE: 800.247.5746
WWW.AJMFG.COM

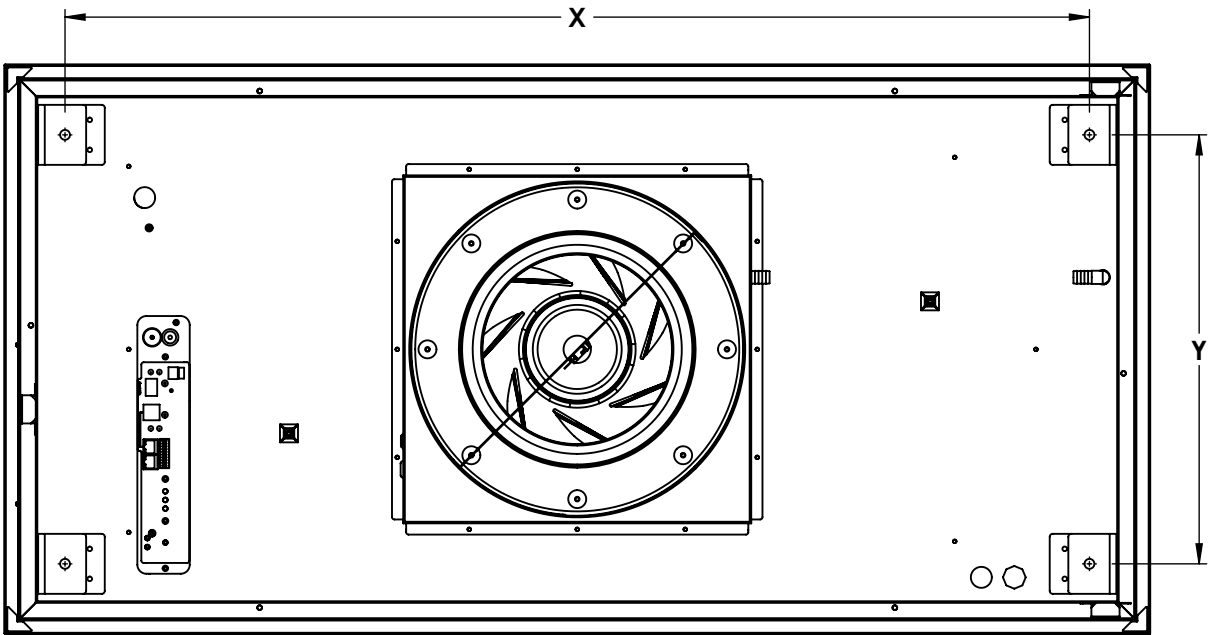
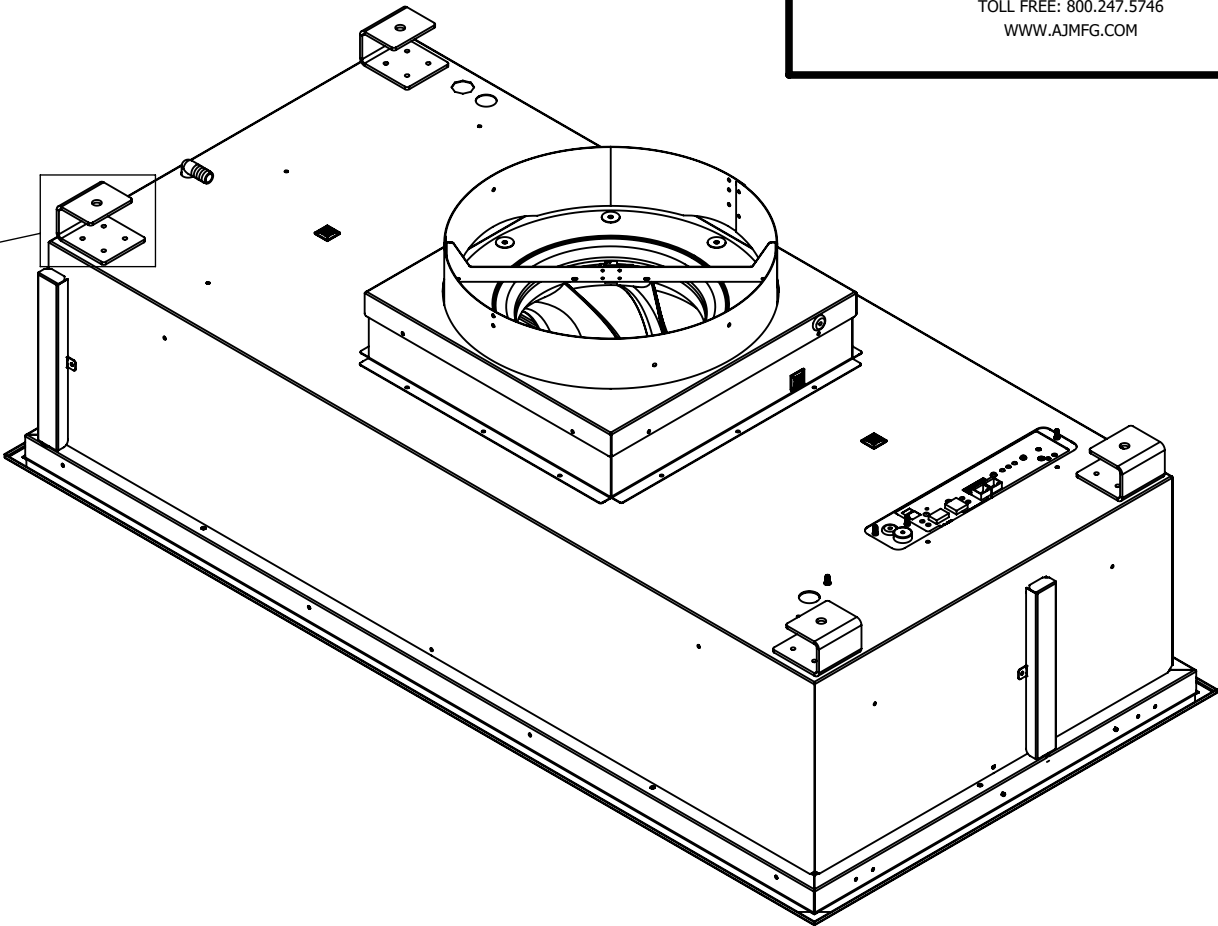
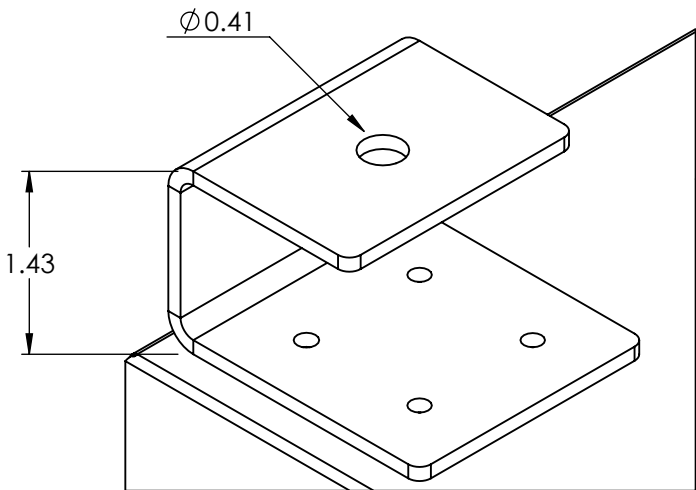

| NOMINAL UNIT SIZE | X | Y |
|-------------------|-------|-------|
| 48 x 24 | 42.68 | 17.87 |
| 36 x 24 | 30.68 | 17.87 |
| 24 x 24 | 18.68 | 17.87 |