

# FRD

## FLAT RADIAL DIFFUSER

### STANDARD CONSTRUCTION

- 304 Stainless Steel
- 51% Perf Face
- Seam Welded Plenum Corners
- Lay-In / Surface Mounting
- Walkable Plenum up to 250lbs
- Hanger Tabs for Unit Support Above Ceiling

### AIRFLOW PATTERNS

- 1-Way
- 2-Way

### FEATURE OPTIONS

- Foil Backed Insulation
  - 1.5" (R=4.2)
  - 2.25" (R=6.0)
- HEPA-Lert Filter Monitor
  - Battery
  - 24V Supply *(By Others)*
- Test Ports
  - 1 Port
  - 2 Ports
- PAO Challenge System *(Requires 2 Test Ports)*
- Seam Welded Inlet Collar
- Hard Ceiling Clamping System
- Drop Face
- Hanger Brackets *(for use with 3/8" threaded rod by others)*
- Custom Unit Depth: \_\_\_\_\_

### INLET OPTIONS

- Inlet Location
  - Top Inlet
  - Side Inlet
  - End Inlet
- Inlet Shape/Size
  - Round - Size: \_\_\_\_\_
  - Oval - Size: \_\_\_\_\_
  - Rectangle - Size: \_\_\_\_\_
    - Flanged

### ORDER SIZE

W: \_\_\_\_\_ x H: \_\_\_\_\_

### MATERIAL OPTIONS

- 316 Stainless Steel

### FINISH OPTIONS

- Polished
- White Antimicrobial Powder Coat
- Other: \_\_\_\_\_

### FILTER OPTIONS

- H14 HEPA Filter - 99.995% on 0.3  $\mu$ m
- ULPA Filter - 99.9995% on 0.12  $\mu$ m

### DAMPER OPTIONS

- SSRD - Butterfly Damper
- SSBD - Bowtie Damper

### DAMPER OPTIONS

- Remote Damper

NOMINAL UNIT SIZE	OVERALL WIDTH (W)	OVERALL HEIGHT (H)	DEPTH (D)	CUTOUT WIDTH (CW)	CUTOUT HEIGHT (CH)	WITH FILTER		
						FILTER	DEPTH (D)	ACTIVE FILTER FACE AREA (SQ.FT.)
24 X 24	23.75	23.75	6.00	23.00	23.00	RSR	9.00	2.00
36 X 24	35.75	23.75	6.00	35.00	23.00		9.00	3.42
48 X 24	47.75	23.75	6.00	47.00	23.00		9.00	4.84

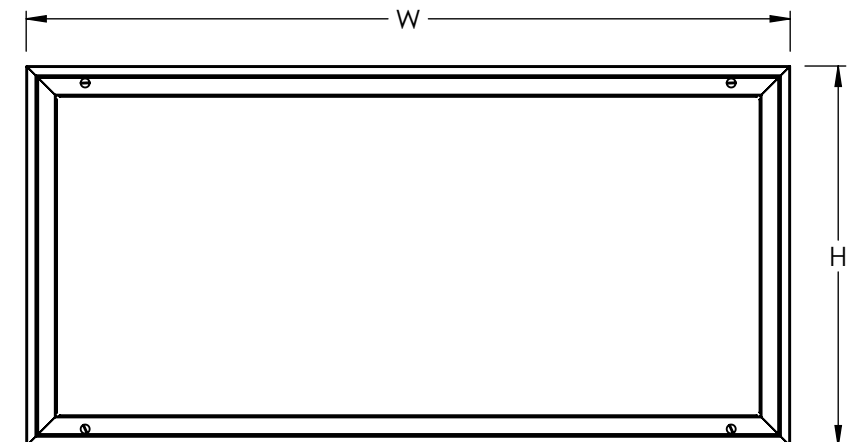
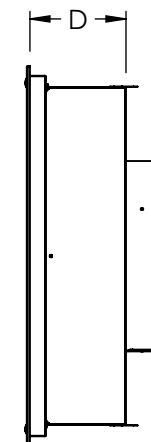
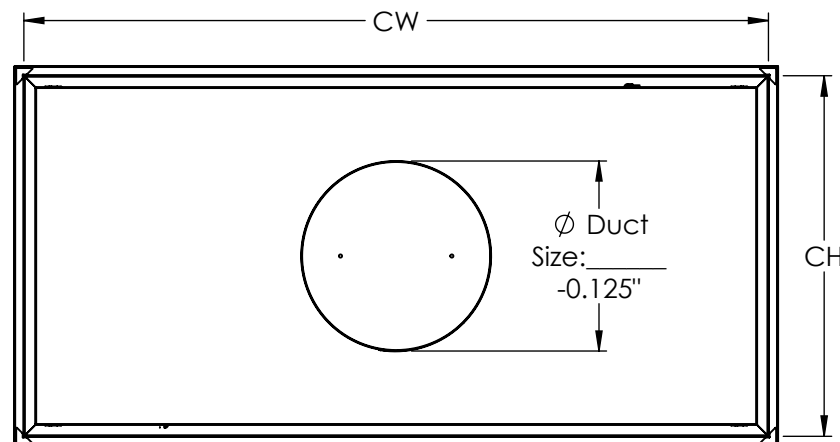

AJ MANUFACTURING CO. INC.  
8701 ELMWOOD AVE #400, KANSAS CITY, MO 64132  
PH: 816.231.5522 / WWW.AJMFG.COM

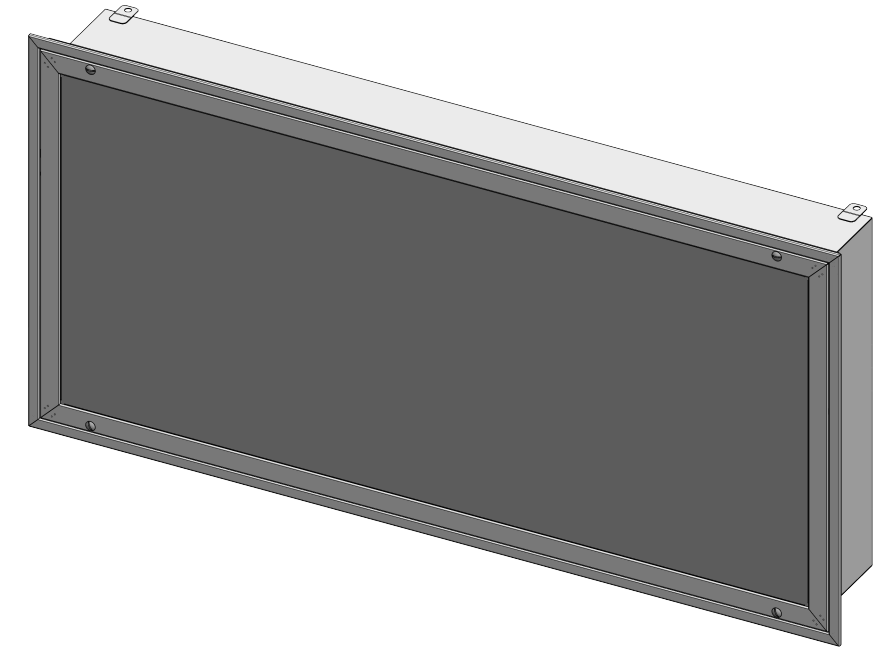

**FRD**  
FLAT RADIAL DIFFUSER



AJ MANUFACTURING CO. INC.  
8701 ELMWOOD AVE #400, KANSAS CITY, MO 64132  
PH: 816.231.5522 / WWW.AJMFG.COM

