

250 (H or V) STAINLESS STEEL

Double Deflection Supply Grille

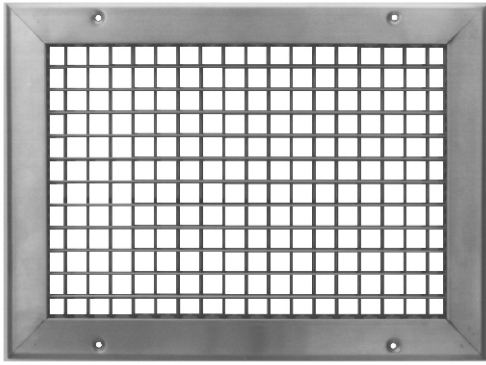

The series 250 double deflection supply grille provides effective directional control of the air stream in one, two, three or four directions. Each bank of bars is pivoted at the front which gives a uniform appearance regardless of blade angle setting.

The hollow, air-foil grille bars are spaced on .750" centers. Each bar is adjusted for the desired air deflection without affecting the setting of any other bar.

Available with horizontal face bars, 250H, or vertical face bars, 250V. Constructed from type 304 stainless, satin finish standard. Type 316 stainless steel also available at an additional cost.

Specify Series S-44 opposed blade damper attached to 250 series to make supply registers. The S-44 OBD assures even distribution of air across the grille face as well as positive volume control.

SEE OPTIONS PAGES:

Factory Standards

- Air foil blades individually adjust.
- Type 304 stainless.
- Countersunk mounting screwholes.
- #6 x 1 1/4" stainless sheet metal screws.
- #4 satin polished finish.

Factory Options (extra charge)

- Type 316 stainless, satin finish.
- 1 1/2" blade centers.
- Painted finish

Minimum W x H	Maximum W x H
4" x 4"	48" x 48"

U.S. Units to Metric Conversion

INCHES x (25.4) = MILLIMETERS

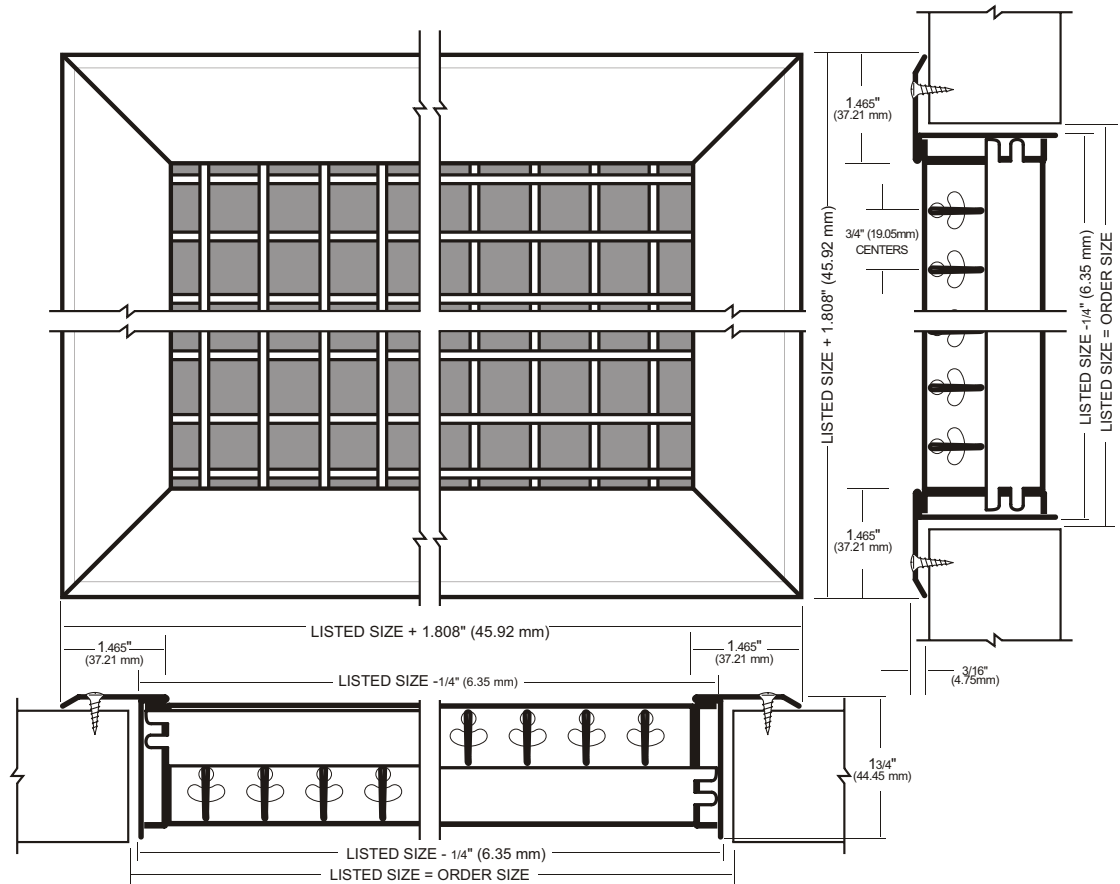

CUSTOMER ORDER NO. --				
JOB --				
ARCHITECT --				
CUSTOMER --				
QTY	ORDER SIZE (W x H)	DAMPER (Y/N)	TAG	304 OR 316